

Microsoft.PL-500.v2022-12-03.q35

□□□□:	PL-500
□□□□:	Microsoft Power Automate RPA Developer
□□□:	Microsoft
□□ □□ □□□:	35
□□:	v2022-12-03
# □□ □:	874
# □□ □□□:	350
https://www.krdump.com/Microsoft.PL-500.v2022-12-03.q35.html	

NEW QUESTION: 1

□□□□ □□□ Power Automate□ □□□□ □□□ □□□□□ □□□□ □□□□ □□□□. □□□□□ □□ □□□□ □□ □□□□ □□□ □□□ □□□□□ □□□ □□□ □ □□□ □ □□. □□□□ □□ □ □□□ □□□□ □□□. □□ □ □□□ □□□□ □□□?

- A. □□ □/□□ □□□□
- B. □ UI □□□
- C. □ □□□□/□□□
- D. □□□

Answer: D ([LEAVE A REPLY](#))

NEW QUESTION: 2

□□□□ □ □□□ □□□□ □ □□□ □□ □□□□ □□□□ □□ □□□ □□□□□. □□□ □ □□□ □□ □□□ □□ □□□□ □□ □□□ □□□□□□ □□□□□. □□ □□□ □□□□ □□ □□□ □□□ □□□□ □□□. □□□□□□□□ □ □□ □□□□ □ □□□ IT □□□ □□□□ □□□ □□□□□ □□□□ □□□. □□□□ □□□□ □□□. □□ □ □□ □□□ □□□□ □□□□ □□□? □□□□□ □□ □□□□ □□ □□□ □□ □□ □□ □□□□ □□□ □□□ □□□□□.



Answer:

Answer Area

Create a cloud flow that is triggered when you create a new record in the Microsoft Dataverse table.

Creayte a desktope flow taht is triggered when you create a new record in the Microsoft Dataverse table.

Create a cloud flow that is triggered when a record is selected in the app.

- 1 - Microsoft Dataverse □□□□□ □ □□□□ □□ □ □□□□□ □□□□ □□□ □□□□□.
- 2 - Microsoft Dataverse □□□□□ □ □□□□ □□□ □ □□□□□ □□□□ □□ □□.
- 3 - □□□ □□□□ □□□ □ □□□□□ □□□□ □□□ □□□□.

NEW QUESTION: 3

□□□ □□ □□□ □□□□ □□□□□.

□□ □□□□ □□□□ □□□□ □□□.

□□ □□□ □□□ □□□? □□□□□ □□ □□□□ □□□ □□□ □□□□□□.

□□: □ □□□ □□□ 1□□ □□□ □□□□.

Answer Area

Flow type	Action
Cloud flow	Power Automate portal only Power Automate Desktop only Either Power Automate portal or Power Automate for desktop
Desktop flow	Power Automate portal only Power Automate Desktop only Either Power Automate portal or Power Automate for desktop

Answer:

Answer Area

Flow type	Action
Cloud flow	Power Automate portal only Power Automate Desktop only Either Power Automate portal or Power Automate for desktop
Desktop flow	Power Automate portal only Power Automate Desktop only Either Power Automate portal or Power Automate for desktop

NEW QUESTION: 4

□□□ □□ □□ □□□ □□□ □□□□ □□□ □□□□.

□□ □□□□ Microsoft Dataverse □□□□ □□ Choice □□□ □□□ □ □□□ □□ □□□.

□□□ □□□□□□□□?

A. □□ □□

B. □□□ □□

C. □□ □□

Answer: B ([LEAVE A REPLY](#))

NEW QUESTION: 5

Microsoft Power Platform □□ □□□ □□□□ □□□□. □□□□ □□□□ □□□ □□ □□□ □□□□□.

□□□ □□ □□ □□□ □□□□ □□□.

□□ 4□□ □□□ □□□□ □□□□ □□□? □□□□□ □□ □□□□ □□ □□□ □□ □□

□□ □□□□ □□□□ □□□□□.

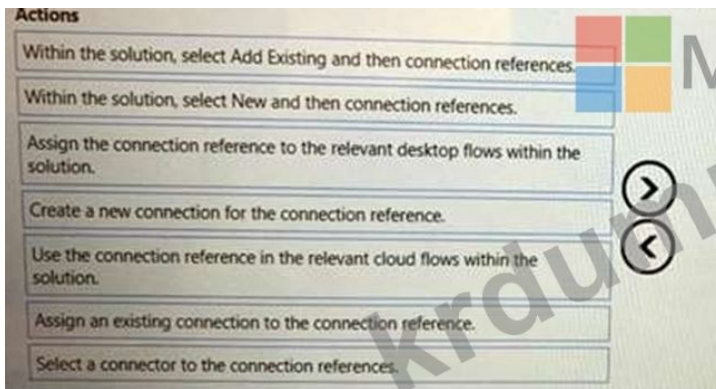

Answer:

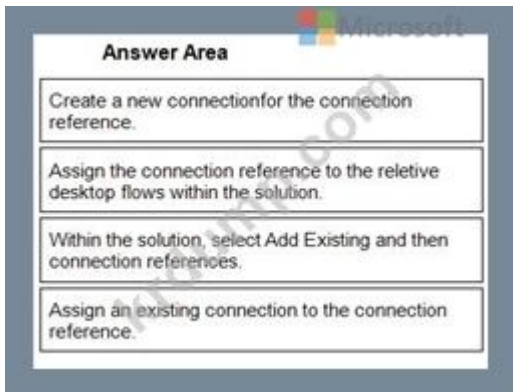

1 - □□ □□□ □□ □ □□□ □□□□.

2 - □□□ □□ □□ □□□□ □□□ □□ □□□ □□□□□.

3 - □□□ □□□ □□ □□ □□□ □□□ □□ □□ □□□ □□□□□.

4 - □□ □□□ □□ □□□ □□□□□.

NEW QUESTION: 6

ERPDataOperations □□□ □□ □□□□ □□□□ □□□.

□□ □□ □□ □□□□ □□□? □□□□□ □□ □□□□ □□□ □□□ □□□□□□□. □□:

□ □□□ □□□ 1□□ □□□ □□□□□.

- B. □□ □□
- C. □□ □□□
- D. □□ □□
- E. □□ □□

Answer: ([SHOW ANSWER](#))

NEW QUESTION: 9

□□□ □□ □□□ □□□□ □□□□ □□□.

□□□ □□□□ □□□? □□□□□ □□□□ □□□ □□□ □□□□□□.

□□: □ □□□ □□□ 1□□ □□□ □□□□.

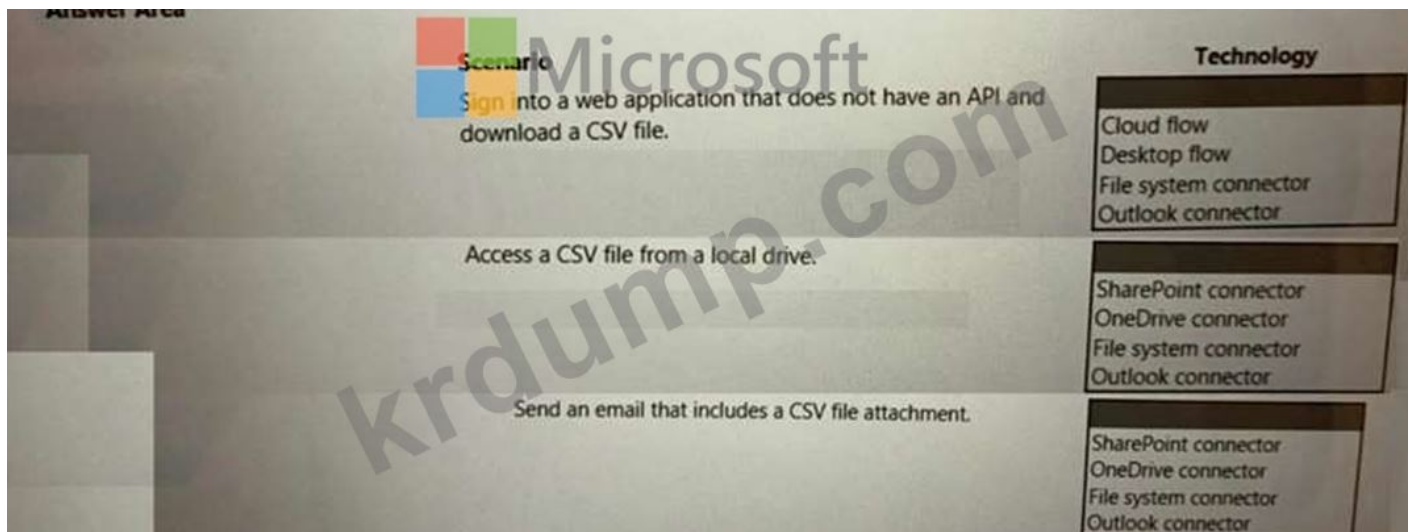

Answer:

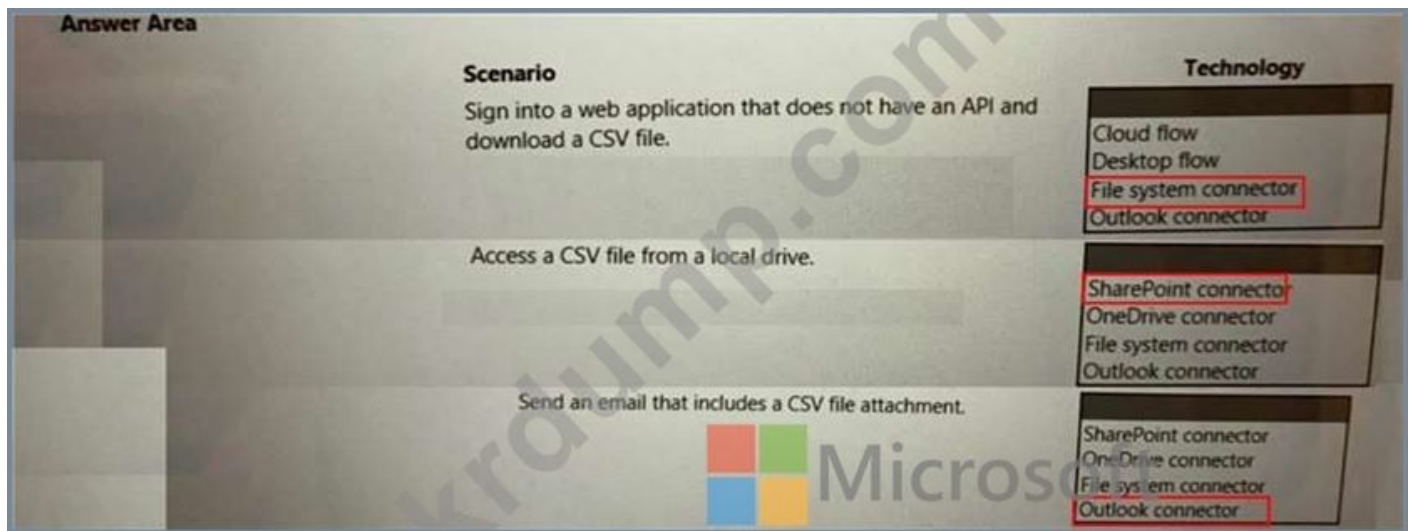

NEW QUESTION: 10

□□ □□□□ □□□ □□□□. □ □□□ □□ □□□□ □□□□ □□□□□.

Power Automate□ □□□ □□□□□□□□□□ □□□ □□□□ □□□.

Power Automate□ □□ □ □□ □□□ □□□□□? □ □□□ □□□ □□□□ □□□□□.

□□: □ □□□ □□□ 1□□ □□□ □□□□.

- A. □□ □□□ □□□ □□□□□.
- B. □□□ □□□ □□□□ □□□□.

- C. □□□□□ □□□ □□□ □□ □ □□ □ □□□ □□□ □□□□□.
- D. □ □□ □□□ □□ □□□ □□□ □□□ □□ □□ □□□□ □□□□□.
- E. □□□ □□ □□□ □□□ □□ □ □□□ □□□ □ □□ □□□ □□□□□.
- F. □ □□ □□□ □□ □□ □□ □ □□□ □□□ □□□□ □□ □□□□ □□□□□.

Answer: A,B,C ([LEAVE A REPLY](#))

NEW QUESTION: 11

MaintenanceScheduler□ □□ □□□ □□□□ □□□.
 □□ □□ □□□ □□□□ □□□? □□□□□ □□ □□□□ □□□ □□□ □□□□□□.
 □□: □ □□□ □□□ 1□□ □□□ □□□□.

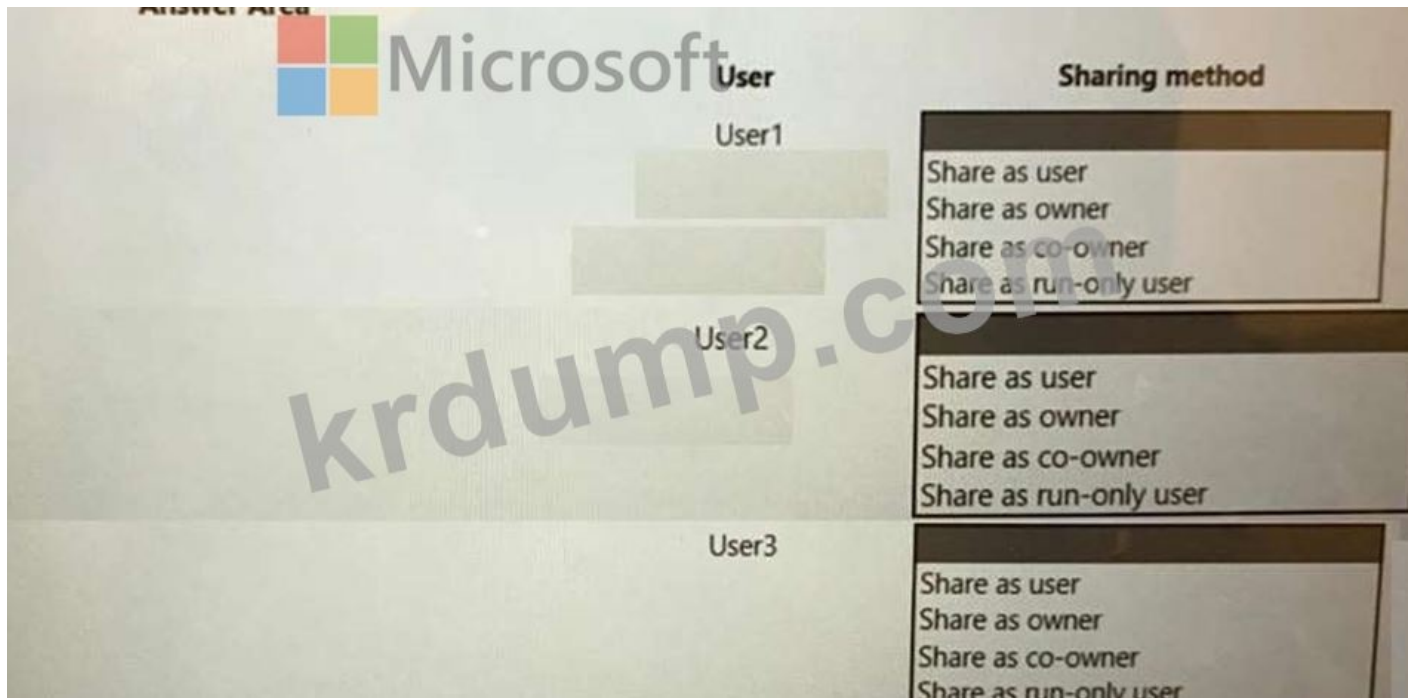

Answer:

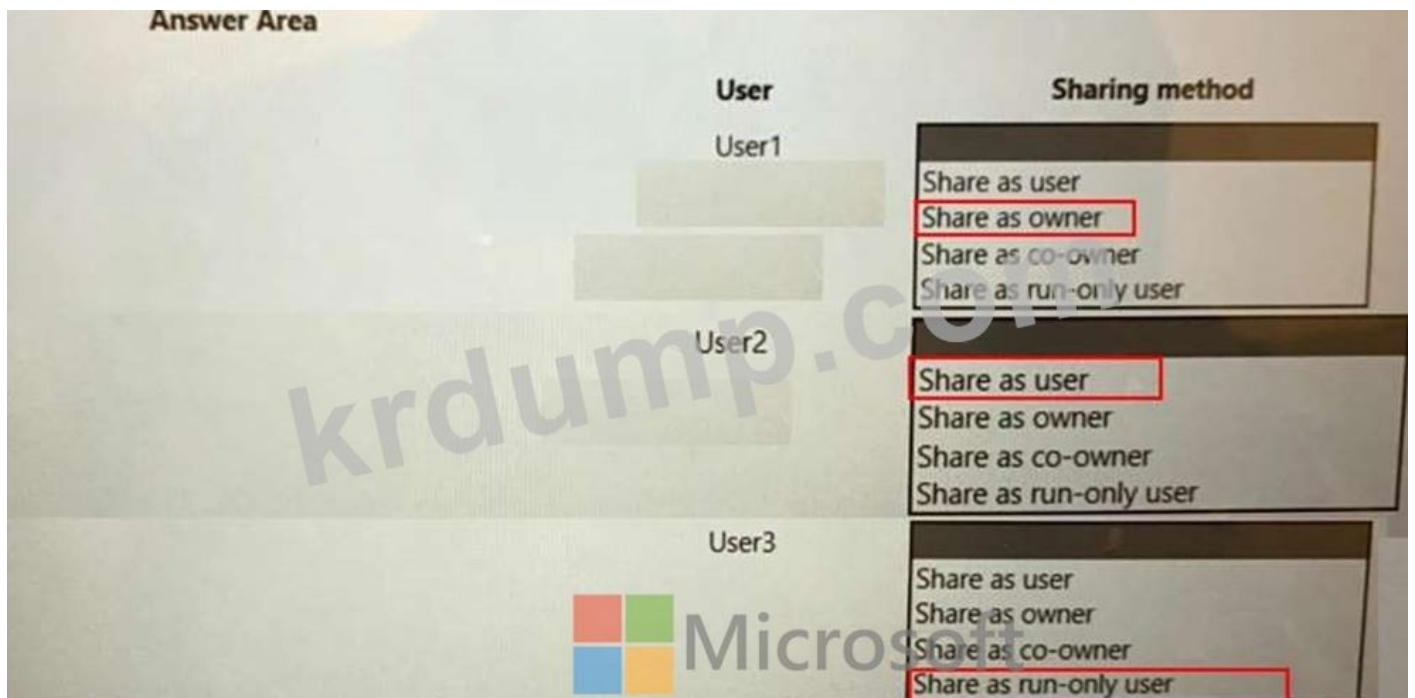

Scenario	Action
Upgrade a single cloud flow from a solution.	<ul style="list-style-type: none"> Clone a patch. Clone a solution. Export as managed solution. Export as unmanaged solution.
Release a new major version of a solution.	<ul style="list-style-type: none"> Clone a patch. Clone a solution. Export as managed solution. Export as unmanaged solution.
Synchronize solution components between development and production environments.	<ul style="list-style-type: none"> Update. Upgrade. Import as managed solution. Import as unmanaged solution.
Overwrite a solution in a production environment.	<ul style="list-style-type: none"> Update. Upgrade. Import as managed solution. Import as unmanaged solution.

NEW QUESTION: 14

RailStatusUpdater □□□□ □□□ □□□□ □□□□ □□□□. □□□ □□□□□□□□□□?

- A. □□ □□□ □□□□□. □ □□□□ □□ □□□ □□□□□□ □□□ □□□□□.
- B. □□□□ □□□ □□□ □ □□□ □□ □□ □□ □□□□□□ □□□□ □□□□ □□□□ □□□□ □.
- C. □ □□□□ □□ □□□ □□□□ □□□□□□□ □□ □□□ □□□□□.
- D. □□□□ □□ □□□ □ □□□ □□ □□ □□ □□□□□□ JavaScript □□□ □□□□□.

Answer: ([SHOW ANSWER](#))

NEW QUESTION: 15

□□□ □□□ □□ □□□ □□□□ □□□□ □□□□.

□□□□ □□□□□□ □□□□ □□□□ □□□□□ □ □ □□□ □□□□□.

□□□ □□ □□□ □□□□ □□ □□□ □□□□ □□□ □□□□ □□□.

□□ □□□□ □□□ □□□□ □□□□? □□□□□ □□□ □□□□ □□□ □□□ □□ □□□ □ □□□□□□.

□ □□□□□□□□. □ □□□□ □□□ □ □, □ □ □□ □□ □□ □□□□ □□ □ □□□□□.

□□□□ □□□ □ □□□ □□ □□□ □□□□□□□ □□□□□ □ □ □□□□□.

□□: □ □□□ □□□ 1□□ □□□ □□□□□.

Process types	Answer Area	Requirement	Process type
<ul style="list-style-type: none"> Process mining Task mining 		<ul style="list-style-type: none"> Identify and eliminate unnecessary process tasks. Reduce total process time. Automate tasks that will accelerate processes and reduce human error. 	<ul style="list-style-type: none"> Process type Process type Process type

Answer:

 Answer Area

In the production environment navigate to the solution contents.

Show solution layers.

Remove all dependences.

Remove all unmanaged layers.

- 1 - □□ □□□□ □□□ □□□□ □□□□□.
- 2 - □□□ □□□□ □□□□□.
- 3 - □□ □□ □□□ □□□□□.
- 4 - □□□□ □□ □□ □□□□ □□□□□.

NEW QUESTION: 18

□□□□ □□□ □□ □□□□.

□□ JSON □□□ □□ □□□□ □□□□□. (□ □□□ □□□□□□ □□□□□.)

```
01 {
02   "customerNumber": 10091,
03   "customerPhones": [
04     "011-2345213",
05     "0114456129"
06   ]
07 }
```



□□□ □□ □□□□ □□□□ JSON □□□□ □□ □□□□□.

□□ □□ □□□□ □□ □□□ □□□ □□□□□□. □□□ □□□□ □□□. □□□ □□□□□ □□□?

- A. □□□□(\%)□ □□□ □□(%)□ □□□□□□□□□.
- B. □□□ □□(/)□ □ □□ □□□ □□(//)□ □□□□.
- C. □□□ □□(/)□ □□□□(V)□ □□□□□□□□□.
- D. □□□ □□(%)□ □ □□ □□□ □□(%%)□ □□□□.

Answer: C ([LEAVE A REPLY](#))

NEW QUESTION: 21

□□ Office 365 □□□□ □□□□. □□□ □□□ □□□□□□. □□□□□ □□□□ □□□ ID□ □□ □□□ □□□ □□□ □□□□□□. □ □□□□□ □ □□□ ID□ □□ □□□ □ □□ □ □□ □□□□□□? □ □□□ □□□ □□□□ □□ □□□. □□: □ □□□ □□□ 1□□ □□□ □□□□.

- A. □□□□ □□ □□□ □□ □□□ □□□ □ □□ □□□ □□□□ □□□ □□□.
- B. □□ □□□ UI □□□ □□□□□ □□□□ □□□□ □□□□□.
- C. □□ □□□ □□□□□ □□□ □□□ □□□□□□□□.
- D. □□ □□□ □□□□□ □□□ □□□ □□□□□□□.

Answer: B,C ([LEAVE A REPLY](#))

NEW QUESTION: 22

□□□□ □□□ □□ □□□ □□□□ □□□□ □□□□ □□□. □□ □ □□ □□□ □□□□ □□□□ □□□? □□□□□ □□ □□□□ □□ □□□ □□ □□ □□ □□□□ □□□ □□□ □□□□□□□.

Actions

- Edit the desktop flow.
- Edit the cloud flow.
- Modify the **Run a flow built with Power Automate for desktop** action.
- Change the desktop flow's priority to High.
- Set the priority value based on the volume for an order.
- Set the desktop flow's queue order based on the volume for an order.
- Select the desktop flow and then select **Move to top**.

Answer area

Microsoft

Answer:

C. □□□ □□□ □□□□ □□ □□□ □□□□□.

D. □□□ □□ □□□□□ □□ □□□ □□□□□ □□□□□ □□□□□.

Answer: (SHOW ANSWER)

NEW QUESTION: 26

□□□□ □□□ □□□□□. □□□ □□□□ 5□□ □□□ □□□□□.

□□□ □□□□ □ □□ □□□□ □□□ □□ □□□□ □□□. On block error □□□ 5□□ □□ □□□□□.

□□ □□□ □□□□ □□□.

□□ □ □□ □□□ □□□□ □□□? □ □□□ □□□□ □□□ □□□□□.

□□: □ □□□ □□□ 1□□ □□□ □□□□.

A. □□ □□ □□□ □□□□□.

B. □□ □□□ □□□□□.

C. □ □□ □□□ □□ On □□ □□□ □□□□□.

D. □□ □□ □□□ □□ □□□□ □□□□ □□□□□.

E. □□ □□ □□□ □□□ □□ □□□□ □□□□ □□□□□.

Answer: B,C,E (LEAVE A REPLY)

NEW QUESTION: 27

□□□ □□□□ CRM(□□ □□ □□) □□ □□□□ □□□□.

□□ □□□ Azure AD(Azure Active Directory) □□□ □□□□ □□□□ □□□□□ □□ □□□

□ □□□ □□ □□□□□ □□□□□. □□ □□□ Microsoft Dataverse□ □□□□□. □□□□

Office 365 Outlook□ □□□□ □ □□□□ □□□□ □□□ □□□.

□□□ □□□□ □□□□ □□□□ □□□.

□□ □□ □□□ □□□□ □□□? □□□□□ □□ □□□□ □□□ □□□ □□□□□□.

Requirement	Action
Trigger the solution using a schedule.	<ul style="list-style-type: none"> Create a cloud flow that uses a manual trigger. Create a cloud flow that uses a schedule trigger. Create a desktop flow and use Windows Task Scheduler to trigger it. Create a desktop flow and trigger it manually.
Access the list of accounts.	<ul style="list-style-type: none"> Use the Relate rows action in a cloud flow. Use the List rows action in a cloud flow. Use the List rows present in a table action in a cloud flow. Use the Get a row action in a cloud flow.
Launch the CRM app.	<ul style="list-style-type: none"> Use the Start service action in a desktop flow. Use the Run application action in a desktop flow. Use the Run a flow built with Power Automate for desktop action in a cloud flow. Use the Run desktop flow action in a desktop flow.
Generate a statement for each account.	<ul style="list-style-type: none"> Use the Apply to each action in a cloud flow. Use the For each action in a desktop flow. Use the Next loop action in a desktop flow. Use the Go to action in a desktop flow.
Send an email with an attachment.	<ul style="list-style-type: none"> Use the Send email action in a desktop flow. Use the Send an email action in a cloud flow. Use the Send Exchange email message action in a desktop flow. Use the Send email message through Outlook action in a desktop flow.

Answer:

Requirement	Action
Trigger the solution using a schedule.	<ul style="list-style-type: none"> Create a cloud flow that uses a manual trigger. Create a cloud flow that uses a schedule trigger. Create a desktop flow and use Windows Task Scheduler to trigger it. Create a desktop flow and trigger it manually.
Access the list of accounts.	<ul style="list-style-type: none"> Use the Relate rows action in a cloud flow. Use the List rows action in a cloud flow. Use the List rows present in a table action in a cloud flow. Use the Get a row action in a cloud flow.
Launch the CRM app.	<ul style="list-style-type: none"> Use the Start service action in a desktop flow. Use the Run application action in a desktop flow. Use the Run a flow built with Power Automate for desktop action in a cloud flow. Use the Run desktop flow action in a desktop flow.
Generate a statement for each account.	<ul style="list-style-type: none"> Use the Apply to each action in a cloud flow. Use the For each action in a desktop flow. Use the Next loop action in a desktop flow. Use the Go to action in a desktop flow.
Send an email with an attachment.	<ul style="list-style-type: none"> Use the Send email action in a desktop flow. Use the Send an email action in a cloud flow. Use the Send Exchange email message action in a desktop flow. Use the Send email message through Outlook action in a desktop flow.

NEW QUESTION: 28

□□□ □□ □□□□ □□ □□□□.

□□□□ □□ □□□ □□□□ □□□.
 □□ □□□ □□□□ □□□? □□□□□ □□ □□□□ □□□ □□□□□□□□.
 □□: □ □□□ □□□ 1□□ □□□ □□□□□.

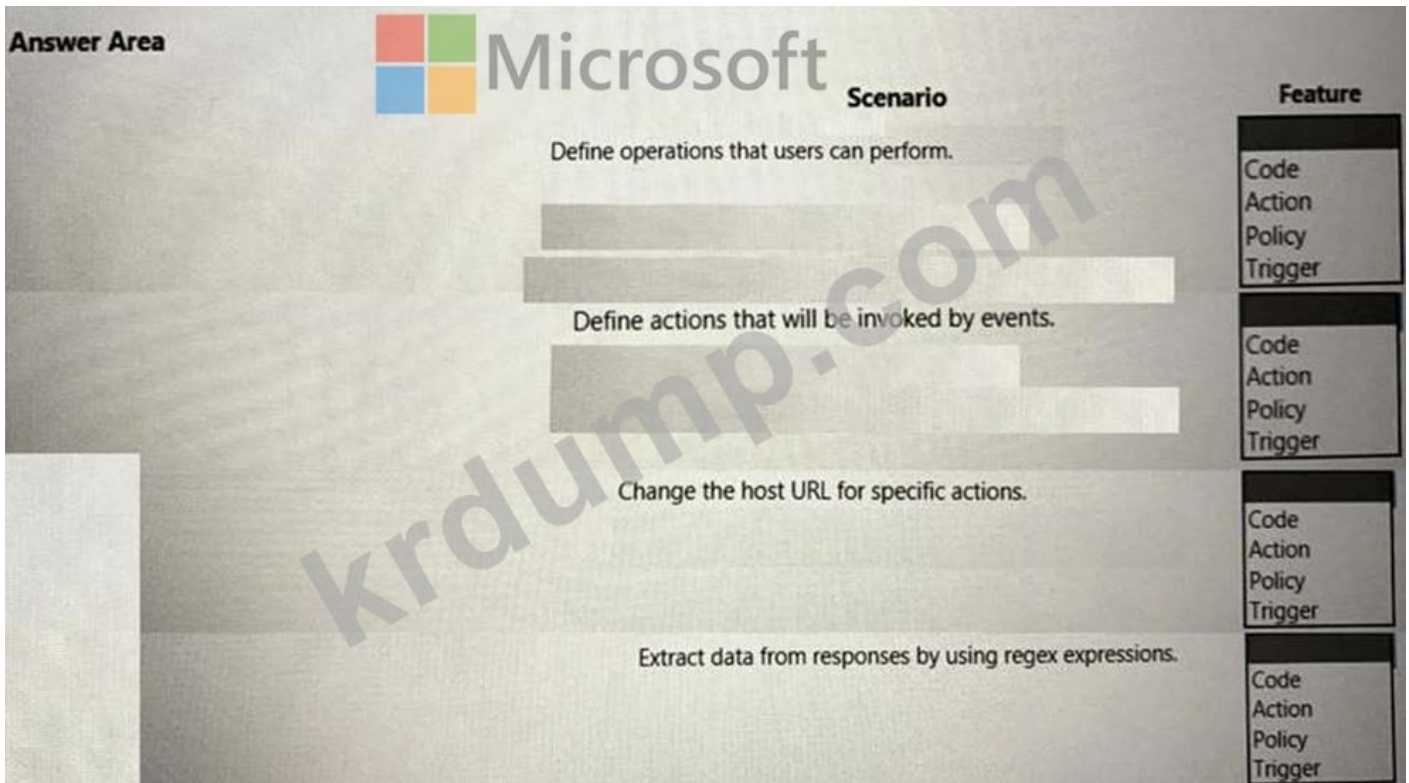

Answer:

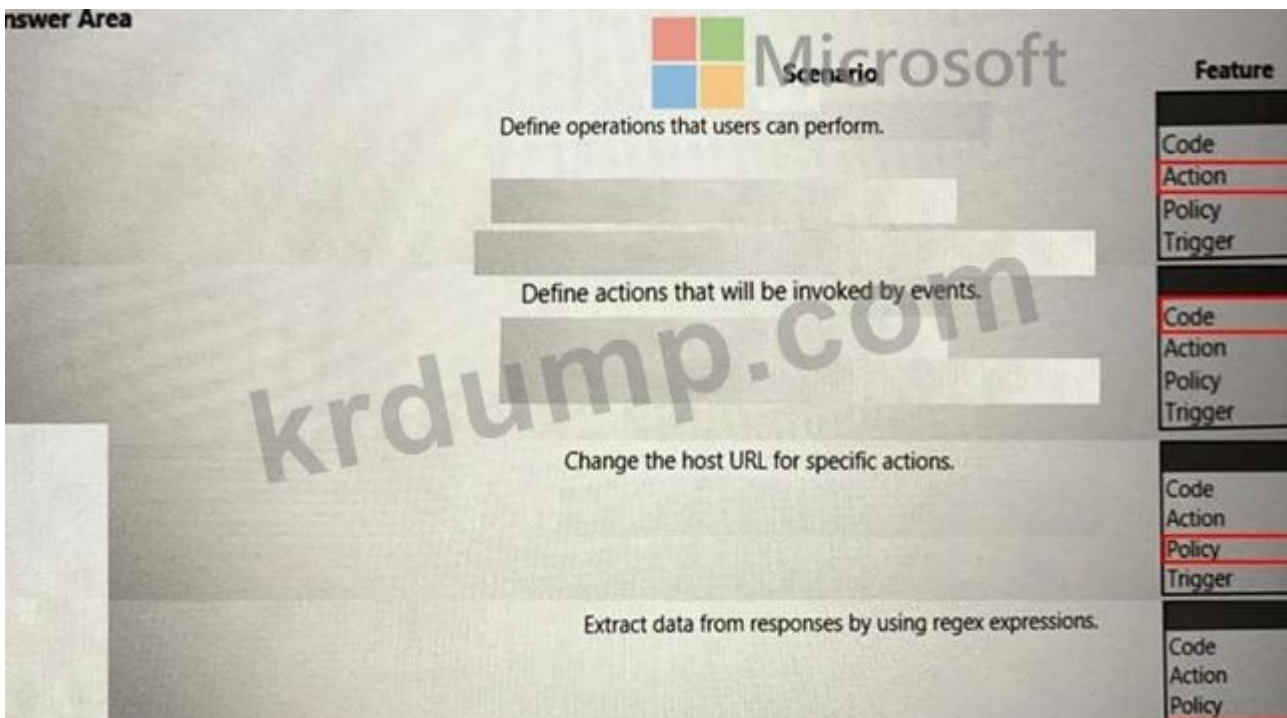

NEW QUESTION: 29

□□□□□□ □□□ □□ □□□□ □□□□ □□□□. □□□□ □□□□ □□□□. □□ □□□□
 □□□□□□?

- A. □□ □□□□□□ Power Automate
- B. □□□ □□ JSON □□

C. API

D.

E. Power Automate

Answer: ([SHOW ANSWER](#))

NEW QUESTION: 30

The screenshot shows a Power Automate flow with the following steps:

1. Get current date and time: Retrieve the current datetime and store it into CurrentDateTime
2. Launch new Microsoft Edge: Launch Microsoft Edge, navigate to 'https://www.google.ca/?gws_rd=ssl' and store the instance into Browser
3. Launch Excel: Launch Excel with a blank document using an existing excel process
4. Get active Excel worksheet: Get the name and index of the active worksheet of the Excel document in instance ExcelInstance
5. Launch Excel: Launch Excel with a blank document using an existing excel process
6. Focus window: Focus window with title "Microsoft Edge"
7. Set window state: Set the state of window with title "Microsoft Edge" to Maximized
8. Get active Excel worksheet: Get the name and index of the active worksheet of the Excel document in instance ExcelInstance?
9. Send keys: Send the following keystrokes: {Control}{R} to the foreground window

Answer Area

Questions

Which line contains a breakpoint?

To which window does the action at step 9 send keystrokes?

Response

1
2
3
4
5

the Edge window launched in step 2
the Excel instance launched in step 3
the Excel instance launched in step 4

Answer:

The screenshot shows the answer area with red boxes highlighting the correct answers:

Questions

Which line contains a breakpoint?

To which window does the action at step 9 send keystrokes?

Response

1
2
3
4
5

the Edge window launched in step 2
the Excel instance launched in step 3
the Excel instance launched in step 4

NEW QUESTION: 31

□□□□ □□□ □□□ □□□□□.
□□□ □□□ □□ □□□□□ □□□.
□□□□ □□□□ □□□ □□□□ □□□.
□□□: □□□ □□□□ □□□□ □□□□ □□□ □□□□. □□□ □□□□ □□□□ □□□
□ □□□ □□□□□. □□□□ □□□ □□□□□?

- A. □
- B. □□□

Answer: A ([LEAVE A REPLY](#))

PL-500 □□ □□□ □□□□□ □□ DumpTop □□ □□□□ □□□ PL-500 □□! DumpTop
□ □□ **PL-500** □□ □□□ □□□□□□□, DumpTop PL-500 □□ □□□ □□□□□□□□
□□□ □□□□□□□□. □□□□ □□□ □□□□ □□ DumpTop PL-500 □□□ □□□□□.
<https://www.dumptop.com/Microsoft/PL-500-dump.html> (172 Q&As Dumps, **30%OFF** Special
Discount: **KrDump**)

NEW QUESTION: 32

□ □□ □ □□□□ □□□ □□□□ Microsoft Dataverse□ □□ □□□□ □□□□ □□□ □□
□ □□□□. □□□ □□□ □□ □□□□ □□□□.
□□□ □□□□ □ □□□ □□ □□□ □□□□□ □□□.
□□□□ □□□□ □□□ □□□□ □□□.
□□ □□: □□ □□□ □□□□.
□□□□ □□□ □□□□□?

- A. □□□
- B. □

Answer: A ([LEAVE A REPLY](#))

NEW QUESTION: 33

□□□□ □□□ □□□□ □□□ □□□□ □□□□. □□□ □□□ □□□□ □□□ □□□□
□□□□ □□ □□□□ □□□□□□□□ □□□. □□ □□□□ □□□□ □□□ □□□□ □□□
□ □□□□□.
□□□□ □□□ □□□□□ □□□□□. □□□ □□ □□□ □□□□ □□□ □□□□□. □□
□ □□□□ □□□□□ □□□ □□□□□. □□□ □□□□ □□□. □□□ □□□□□□□□□?

- A. □□□ □□□□ □□ □□□ □□□□□.
- B. □□□□ □□□□ □□□□ □□ □□ □□□ □□□ □□□ □□□□□.
- C. □□□ □□□□ OneDrive □□□□ □□□□□.
- D. □□□ □□□□ □□□□□□.

Answer: A ([LEAVE A REPLY](#))

NEW QUESTION: 34

□□□ Power Automate □□□ □□□□□. □□□□ □□□ □□ □□□ □□□ □□ □□ □□ □□□□ □□□□ □□□□ □□□ □□□□ □□□? □□□ □□: □ □□□ □□□ 100 □□ □□□□.

Answer Area

Requirement	Value
You select the Send a copy button from the flow portal to send the flow to a business user group.	the Solutions page the Shared with me tab of the My flows page the Shared with me tab of the Templates page
You select the Share button from the portal to share the flow with business users.	the Solutions page the Shared with me tab of the My flows page the Shared with me tab of the Templates page

Answer:

Answer Area

Requirement	Value
You select the Send a copy button from the flow portal to send the flow to a business user group.	the Solutions page the Shared with me tab of the <u>My flows</u> page the Shared with me tab of the <u>Templates</u> page
You select the Share button from the portal to share the flow with business users.	the Solutions page the Shared with me tab of the My flows page the Shared with me tab of the Templates page

NEW QUESTION: 35

□□□□□□ □□□ □□□□□□ □□□□. □ □□□□ □□ HI ML □□□□ □□□□ □□□ □ □□□ □□□□□.

```
<div _ngcontent-c1="" class="col s6 m6 l6">  
  <div class="ng-invalid ng-dirty ng-touched">  
    <label>Field1</label><input ng-reflect-name="labelField1" class="ng-pristine ng-invalid ng-touched">  
  </div>  
</div>
```

□ □□□ □□□□ □□□□ □□□□□□.
□□□ □□□□ □□ □□□.
□□ □ □□ □□ □□ □□ □□□ □□ □□□□□□. □□□ □□□ □□□□ □□□□□□.
□□: □ □□□ □□□ 100 □□□ □□□□□.

Answer Area

Statement	Yes	No
You configure the following selector: <code>input[ng-reflect-name="labelField1"]</code> The automation will add data to the form.	<input type="radio"/>	<input type="radio"/>
You configure the following selector: <code>div:has(label:contains("field1")) > input</code> The automation will add data to the form.	<input type="radio"/>	<input type="radio"/>
You add the Run JavaScript function on web page action to the flow.	<input type="radio"/>	<input type="radio"/>

```
function ExecuteScript() {
  $("div:contains('field1') > input")
  .val("Field's 1 value")
}
```

The action adds data to the form.

Answer:

Answer Area

Statement	Yes	No
You configure the following selector: <code>input[ng-reflect-name="labelField1"]</code> The automation will add data to the form.	<input checked="" type="radio"/>	<input type="radio"/>
You configure the following selector: <code>div:has(label:contains("field1")) > input</code> The automation will add data to the form.	<input checked="" type="radio"/>	<input type="radio"/>
You add the Run JavaScript function on web page action to the flow.	<input type="radio"/>	<input checked="" type="radio"/>

```
function ExecuteScript() {
  $("div:contains('field1') > input")
  .val("Field's 1 value")
}
```

The action adds data to the form.

PL-500 ☐☐ ☐☐☐ ☐☐☐☐☐ ☐☐ DumpTop ☐☐ ☐☐☐☐ ☐☐☐ PL-500 ☐☐! DumpTop
 ☐ ☐☐ **PL-500** ☐☐ ☐☐☐ ☐☐☐☐☐☐, DumpTop PL-500 ☐☐ ☐☐☐ ☐☐☐☐☐☐☐☐
 ☐☐☐ ☐☐☐☐☐☐☐. ☐☐☐☐ ☐☐☐☐ ☐☐☐☐ ☐☐ DumpTop PL-500 ☐☐☐ ☐☐☐☐☐.
<https://www.dumptop.com/Microsoft/PL-500-dump.html> (172 Q&As Dumps, **30%OFF Special Discount: KrDump**)